

Solar LED Flood Lights

100W / 150W / 200W / 300W



PATENT

Pro-Double MPPT Solar Charger Controller



LIGHT UP **DAILY**



IP65 Waterproof



Warning Function & Lighting



Sensor

The sensing distance is about 10-12 meters The luminaire is full illuminated in the sensing range, otherwise it is 20% bright



Three Lighting Options



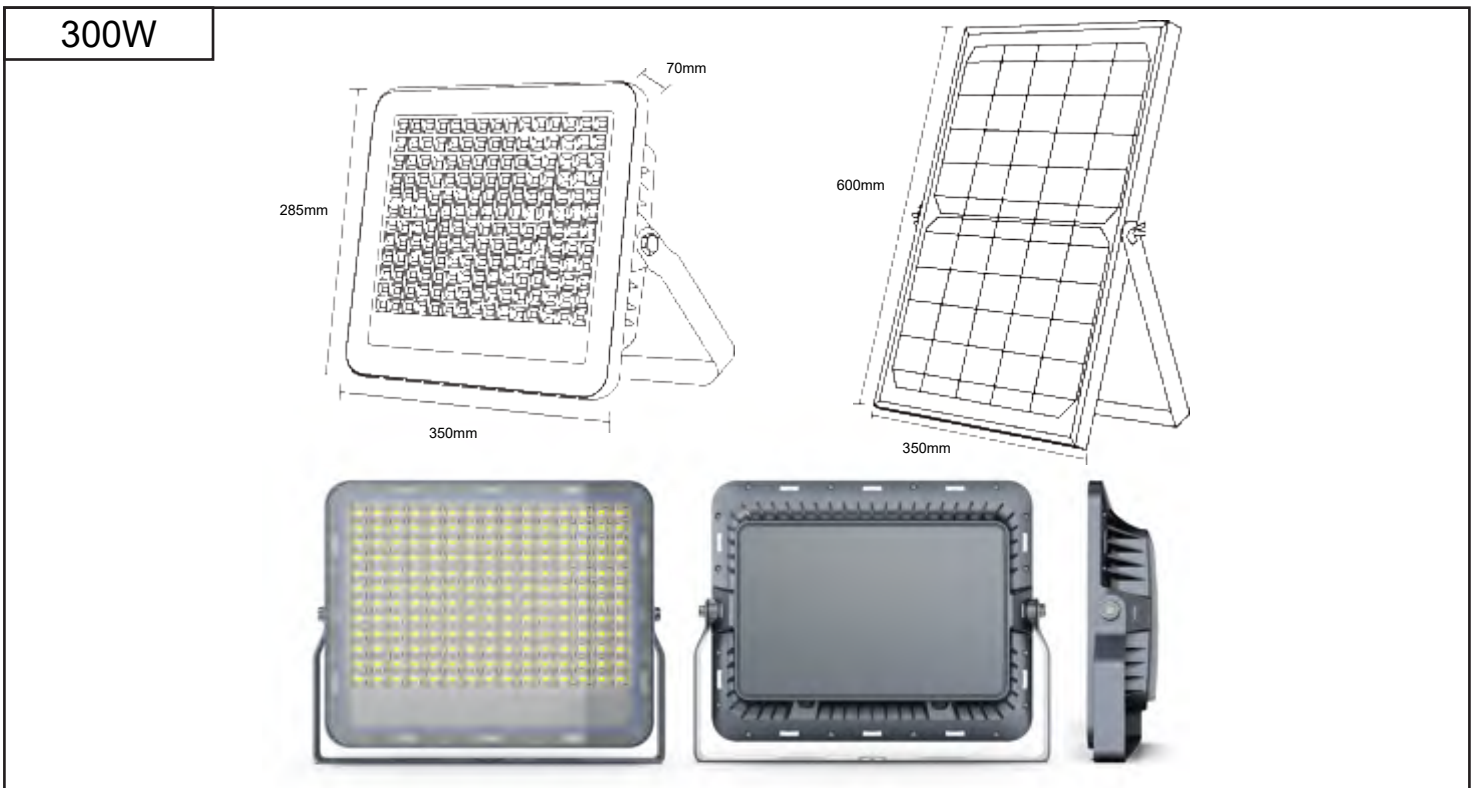
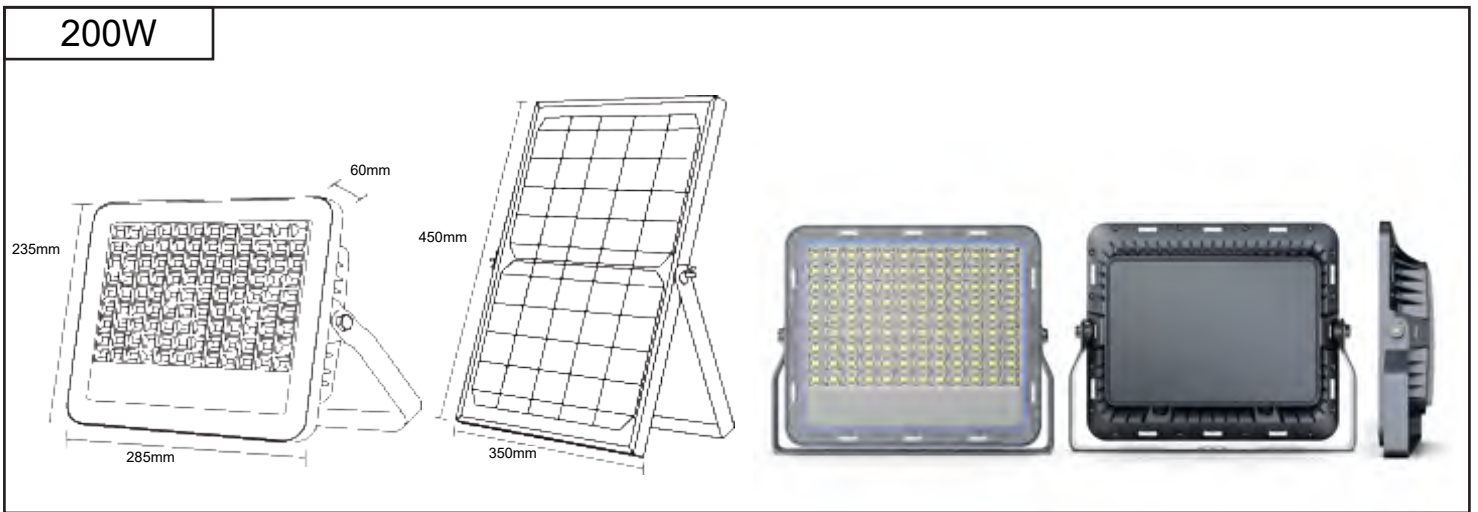
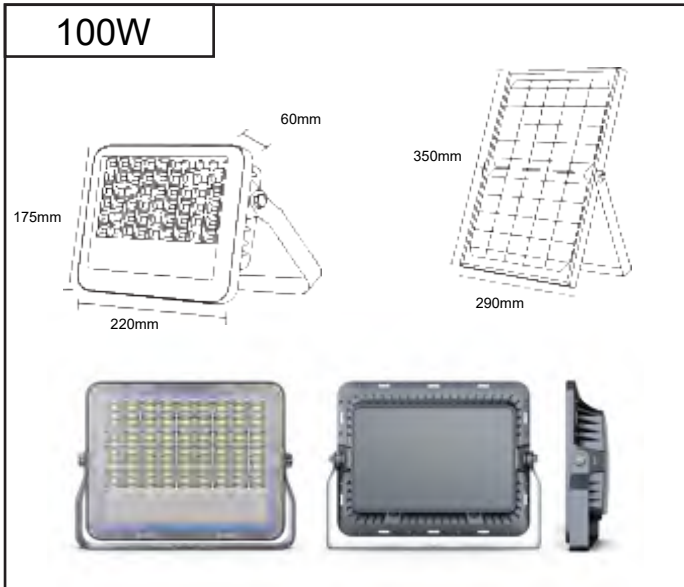

Power	100W	150W	200W	300W
Solar Panel	Monocrystalline Silicon 6V 18W	Monocrystalline Silicon 6V 25W	Monocrystalline Silicon 6V 30W	Monocrystalline Silicon 6V 40W
Battery	Lithium Battery (LiFePO4) 3.2V 12AH	Lithium Battery (LiFePO4) 3.2V 18AH	Lithium Battery (LiFePO4) 3.2V 24AH	Lithium Battery (LiFePO4) 3.2V 30AH
LED	Epistar 2835 108pcs	Epistar 2835 176pcs	Epistar 2835 216pcs	Epistar 2835 360pcs
Color	3000K/4000K/6000K Adjustable			
Beam Angel	85°*145°			
Working Time	12 hours lights at night			
Charging Time	6-8 hours full charge			
IP	IP65	IP65	IP65	IP65
Warranty	2 Years	2 Years	2 Years	2 Years
Lamp Size (mm)	220*175*60	265*210*60	285*230*60	350*285*70
Solar Panel Size (mm)	350*290*17	350*350*17	350*450*17	600*350*17
Packing Size (mm)	70.5*38*32 19KG/6PCS	59*38*38 22KG/5PCS	48*43*38 21KG/4PCS	62.5*53*38 25KG/4PCS

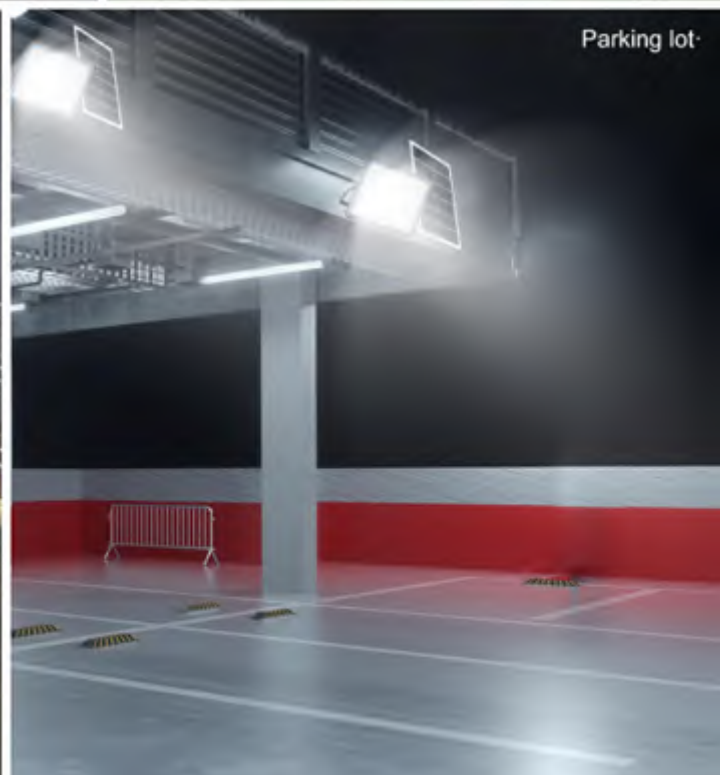

Remote:

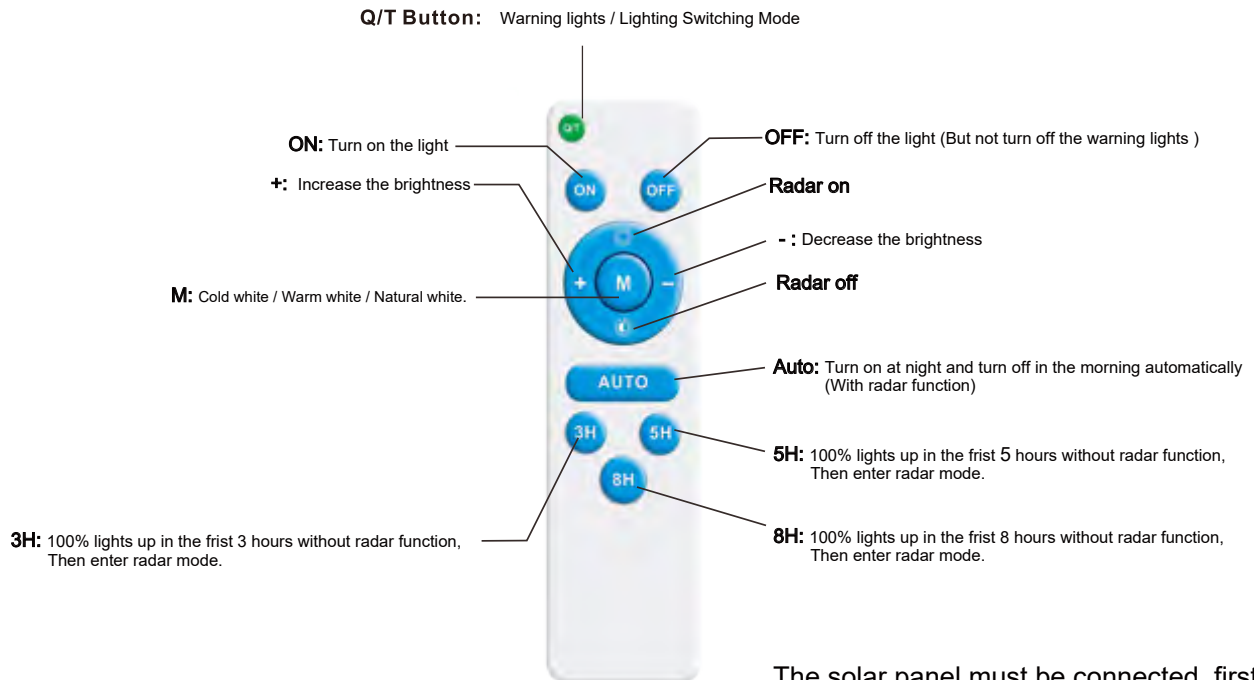

Remark:

- 1.Radar mode:** 100% brightness when people come around
20% brightness when people leave
- 2.Green indicator lights:** 4 level Battery capacity, each one level means 25% battery capacity.
- 3.Red & Blue indicator lights:** Alternate flashing, warning function.

Packing



1. Wall-Mounted

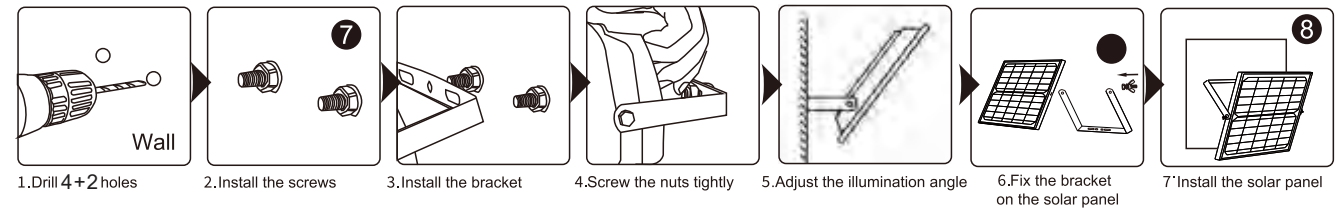

1. Drill 4+2 holes

2. Install the screws

3. Install the bracket

4. Screw the nuts tightly

5. Adjust the illumination angle

6. Fix the bracket on the solar panel

7. Install the solar panel

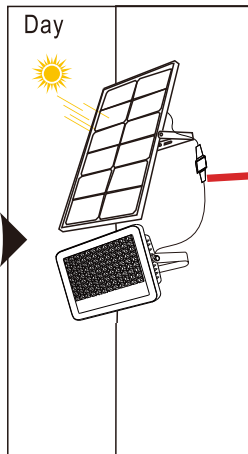

8. Adjust the panel to the direction with adequate sunlight

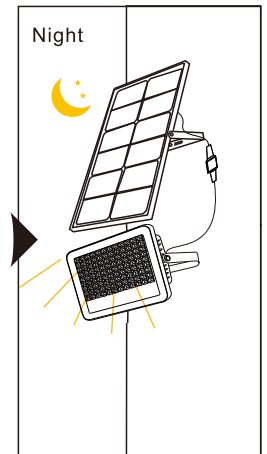
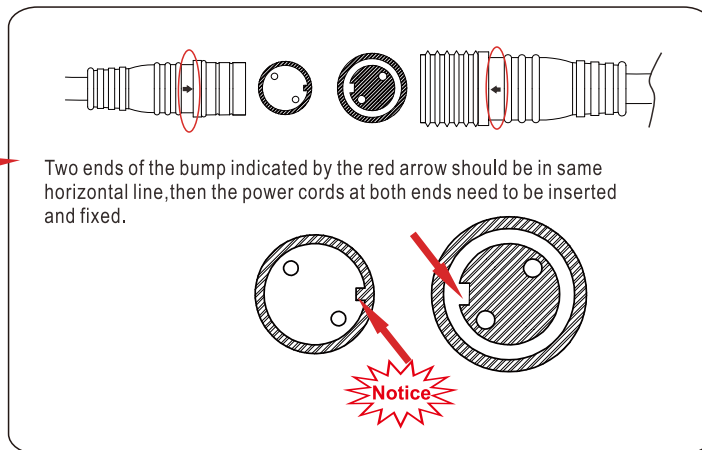

9. Installation is finished, it will light up at night

2. Pole-Mounted

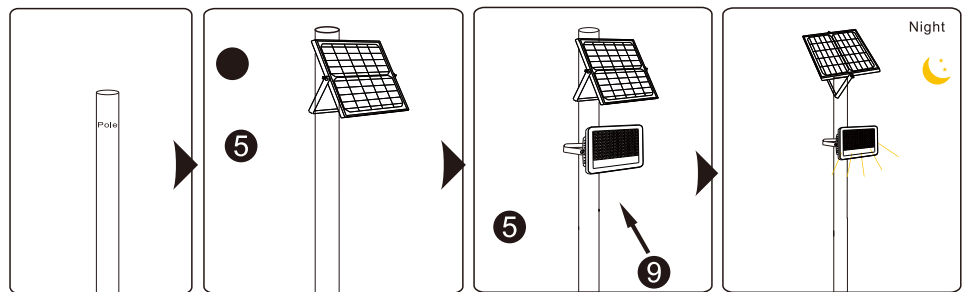

1. Stand up the light pole

2. Install the solar panel and adjust the panel direction to the direction with

3. Install the solar light

4. Installation is finished, it will light up at night

HOW THE SOLAR LIGHT WORKS:

During the daytime, the solar panel converts sun power into electricity and charging the battery. At night, the light turn on automatically using the electricity stored in the battery.

PRECAUTION:

Please install in a sunny place where it can receive direct sunlight for at least 6~8 hours each day , avoid installation near a tree which creates overcast on solar panel, or it will affects the charging effect. Any shadow or overcast on solar panel during the day impact the effective charging of battery. Then the brightness will be changed when battery power is low. The selected locations should not be near lights, otherwise maybe cause the solar light to turn off prematurely.

ATTENTION FOR THE USE OF THE FIRST TIME:

When you get the solar light, the battery is only 50%-60% full charge because of shipping. So we suggest you please open the switch and then place the solar light in a location where it can receive a full 6-8 hours of sun power to recharging the battery to reach maximum capacity, and then to install the solar light where you want.

